



*Yug*  
**HEIGHTS**

*Escalate Your Living*

18 Storey Residential Tower with Podium Garden  
SHILPHATA





## About Us

Prathemesh Group established since 1995 believes in satisfying our Customer demands and needs. We are established home makers of Navi-Mumbai.

The bond we share with our customers extends beyond business with emphasis on delivery & after sales services

Living up to our Company policy we bring dreams alive by providing exclusive life style homes at affordable prices.

## About Yug Heights

Nestled in one of the most promising upcoming residential areas of MMRDA region, Yug Heights promises to provide the perfect blend of budget housing with luxurious living.



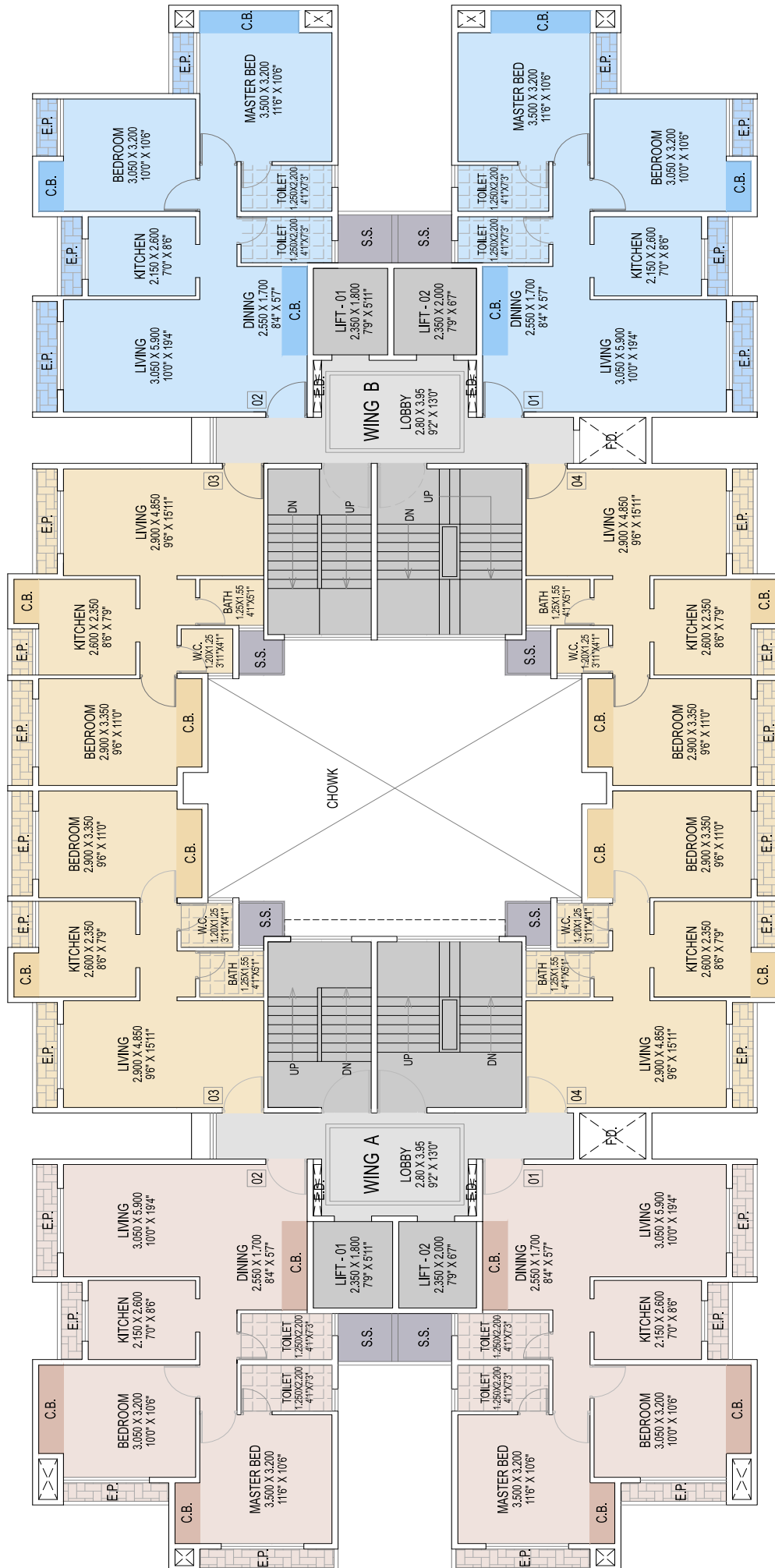

## TYPICAL FLOOR PLAN

'A' WING

1ST,2ND,3RD,4TH,5TH,6TH,7TH,9TH,10TH,11TH,12TH,14TH,15TH,16TH,17TH FLOOR PLAN

'B' WING

1ST,2ND,3RD,4TH,5TH,6TH,7TH,9TH,10TH,11TH,12TH,14TH,15TH,16TH,17TH FLOOR PLAN

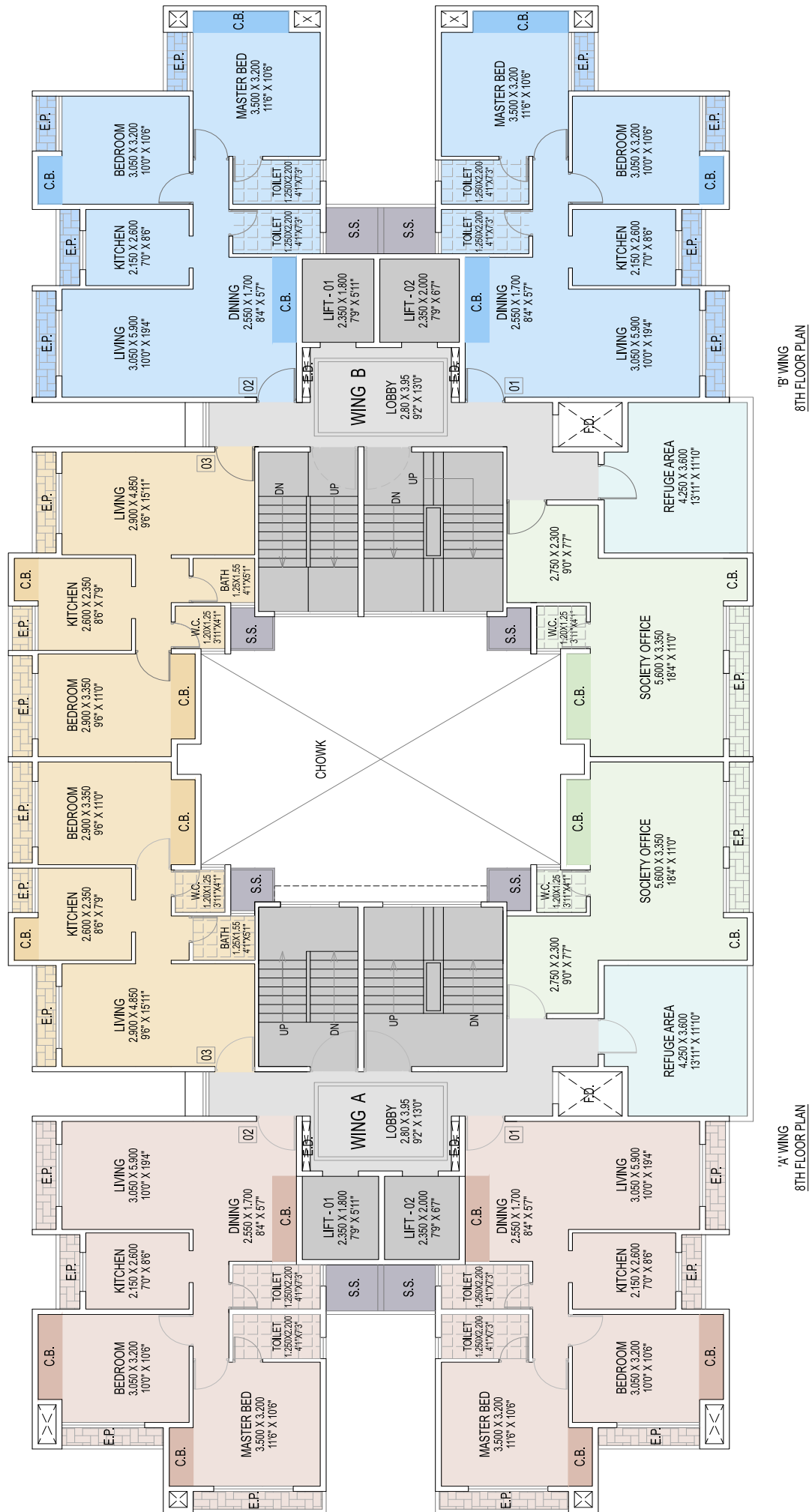

8TH FLOOR PLAN

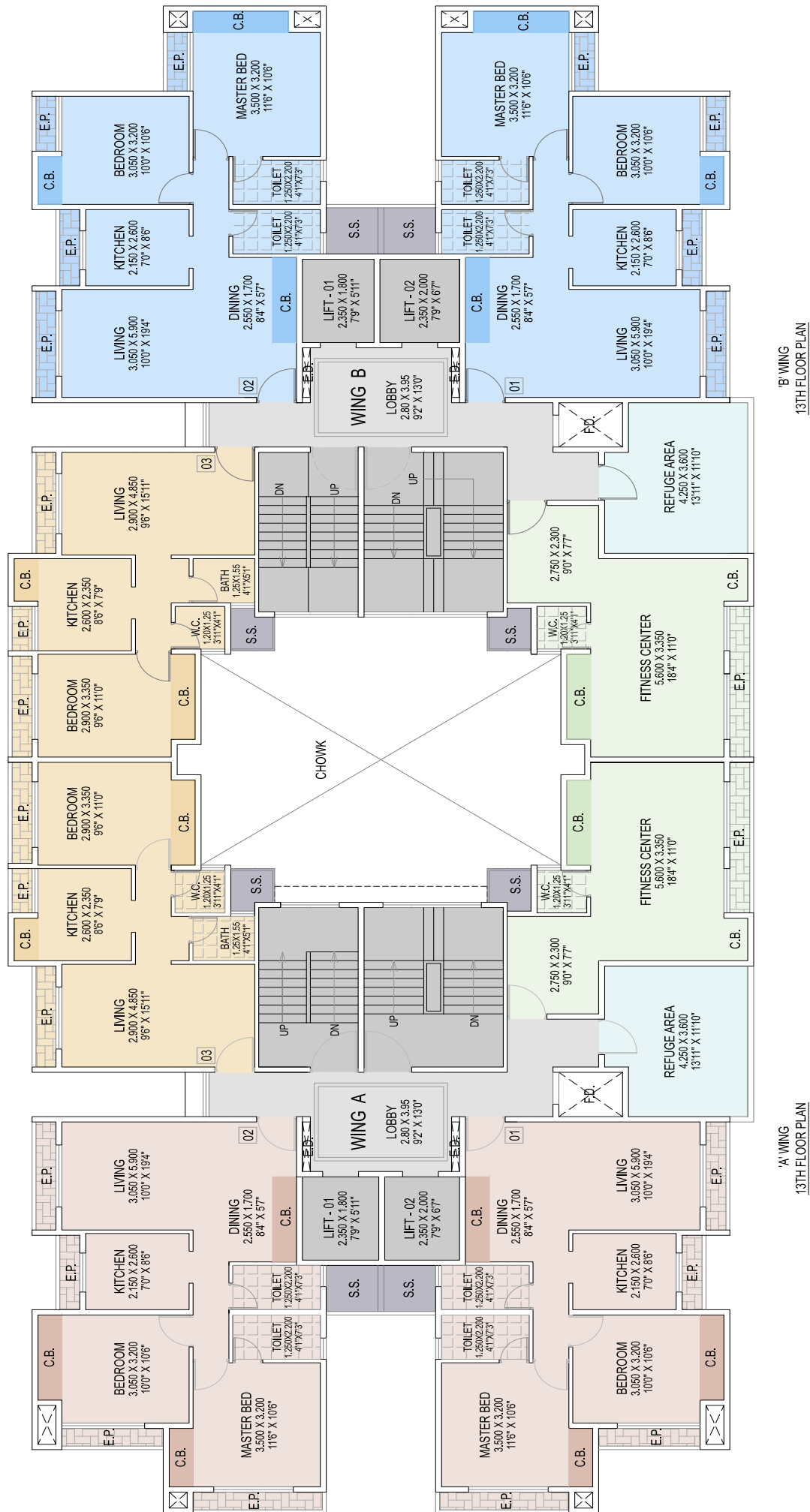

13TH FLOOR PLAN





**1 BHK Room**



**2 BHK Room**

## External Amenities

- Earthquake resistant RCC Structure
- Attractive Elevation & Entrance
- Fitness Centre
- Children Play Area
- Recreation Area
- Society Office
- Video Room (CCTV)
- Power Backup-Inverter for common facilities
- Solar Power
- Rain Water Harvesting
- Stilt Stack Parking
- Security Cabin, Meter Room & Transformer



## Internal Amenities

- Designer Lobby with Marble Flooring
- Intercom Facility
- Hi-Tech Fire Fighting System
- Exclusive High-speed Lifts
- 2' x 2' flooring vitrified Tiles in all rooms.
- Granite platform in kitchen with S.S. Sink
- 3 ft. height Dado in Kitchen
- Door height Ceramic tiles in bathrooms with anti-skid flooring
- Anodised Aluminium Sliding windows with tinted glasses
- Concealed Copper wiring with Modular Switches
- Concealed Plumbing with premium fittings
- Designer laminated flush front door with brass fittings
- Good ventilation & Vastu compliant
- Gypsum / Putty on walls



## Location Plan

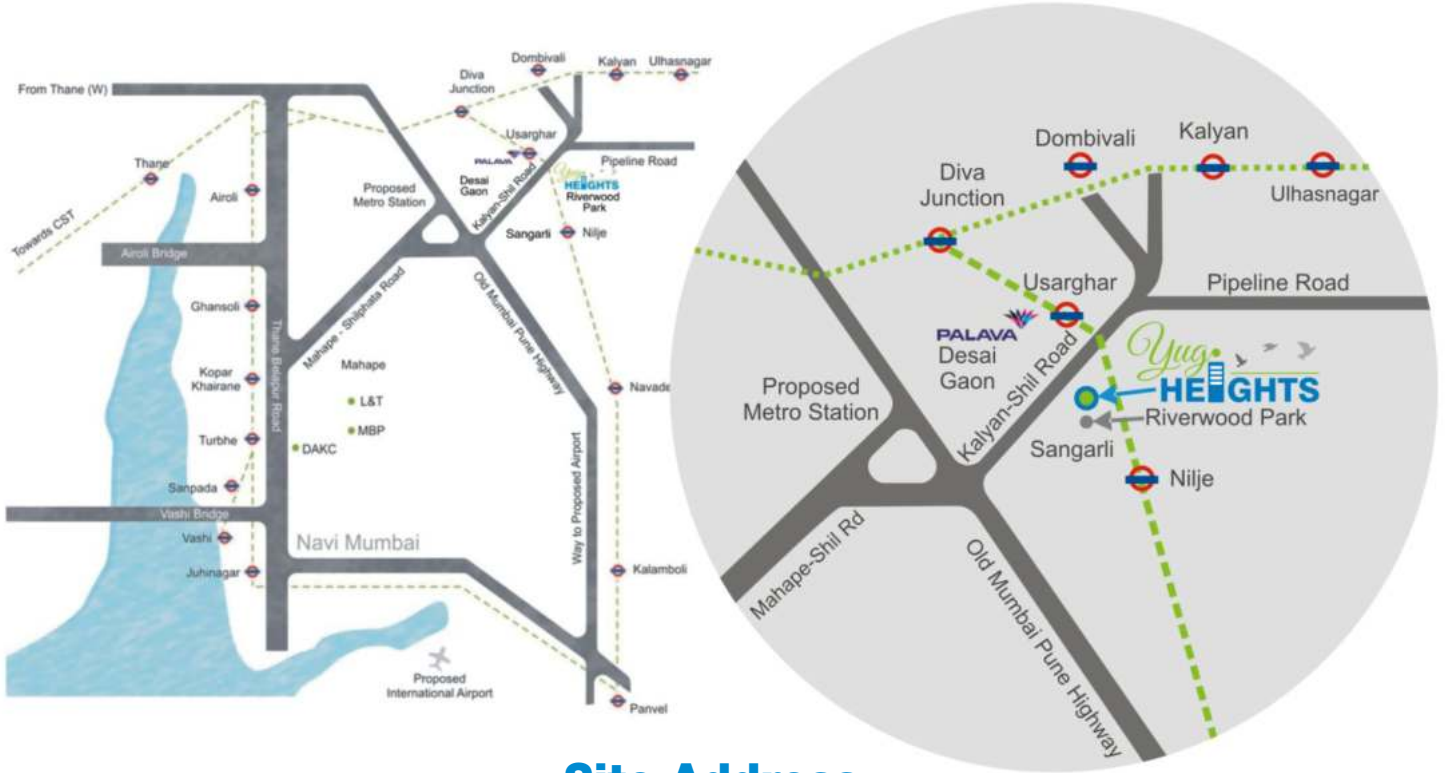

## Site Address

Survey No.19, H.No.5 at Village-Sangarli, Shil-Kalyan Road, Taluka and District - Thane, Pin - 421 204.

## Location Advantages

- Connectivity with Navi Mumbai, Thane, Dombivali, Kalyan
- 30 mins drive to the proposed International Airport
- Bus services by TMT, NMMT, KDMT & ST
- 5 mins from Nilje Railway Station
- Banks, Market, Schools, Hospitals, Colleges & Shopping Mall all in vicinity
- Near Mahape IT Hub

**MAHA RERA No.: P51700014553**

**R.S.Constructions (Builders & Developers)**

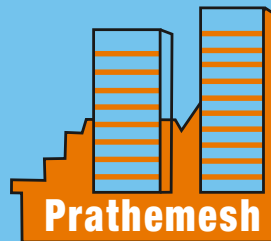

*Prathamesh Group*  
*Bringing dreams alive*

**Office Address:**

**407, Punit Chambers, Plot No.796-C, Sector 18, Turbhe, Vashi, Navi Mumbai - 400 703.**

**Tel.: 6510 8989 / 6510 8966    Telefax: 2788 2333**

**E-mail : [info@prathameshgroup.com](mailto:info@prathameshgroup.com) / [prathameshconstruction@yahoo.com](mailto:prathameshconstruction@yahoo.com)**

**Visit us at : [www.prathameshgroup.com](http://www.prathameshgroup.com)**

The project has been registered via MahaRERA registration number: P51700014553 and is available on the website : <https://maharera.mahaonline.gov.in> under registered projects.